



SouthForrest
Solicitors and Estate Agents



Plots 1, 2 & 4, Drumchork Wood, Aultbea, Ross shire

Building plots with detailed planning permission enjoying views over Aultbea and Loch Ewe.

Additional field and woodland available by separate negotiation.

Prices from £50,000



These building plots are pleasantly situated within an area of young woodland and enjoy spectacular views over Loch Ewe and Aultbea to the Western Isles. Detailed planning permission exists for detached 3 bedroom/2public room 1 1/2 storey dwelling houses. Mains water and electricity are on site and awaiting connection and mains drainage is closeby.

Plot 1
Approximately 0.68 acres

Plot 2
Approximately 0.51 acres

Plot 4
Approximately 0.74 acres

The Aultbea and surrounding area has some of the most beautiful and rugged loch and mountain scenery in Scotland and is popular for walking, climbing, fishing, bird watching and water sports. Aultbea has a good range of amenities including shops, hotels, doctors' surgery and church. Primary schooling can be found in the area and secondary schooling in Gairloch. Inverness, the capital of the highlands, is about 77 miles from Aultbea and offers extensive shopping, leisure and recreational facilities.

Directions

From Inverness take the A9 north, at the Tore roundabout take the A835 heading for Ullapool. Continue on this road until you reach the Braemore Junction. Take the A832 here and continue on this road to the village of Aultbea. Follow the main road until you reach the sign for Aultbea Lodges. Turn left on the minor road which leads uphill towards the entrance to the lodges and the plot is sign posted on the left.

Planning Reference

Plot 1: 07/00380/FULRC

Plot 2: 07/00381/FULRC

Plot 4: 07/00383/FULRC

Postcode

IV22 2HU

Entry

By negotiation

Price

Plot 1 Offers around £70,000

Plot 2 Offers around £50,000

Plot 4 Offers around £75,000

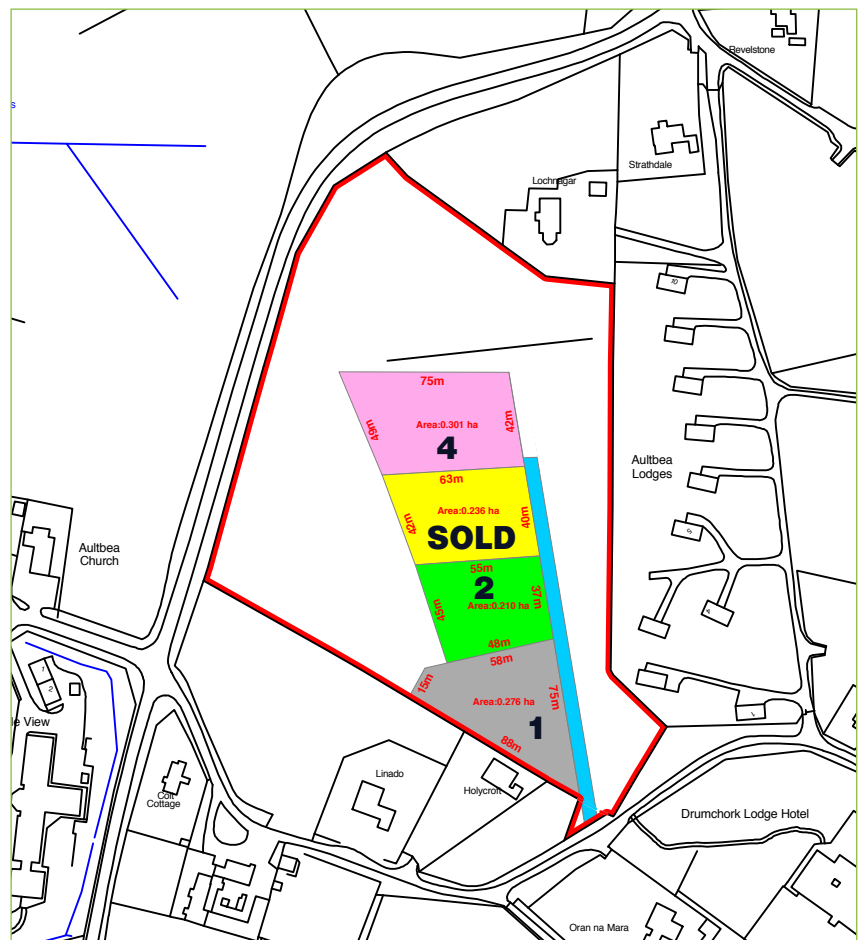

8 Ardross Terrace, Inverness IV3 5NW

T. +44 (0)1463 237171

F. +44 (0)1463 243548

DX IN 16 ▪ LP 6 Inverness 1

E. email@southforrest.co.uk

www.southforrest.co.uk

These particulars are believed to be correct, but are not guaranteed. They do not form part of a contract and a purchaser will not be entitled to rely on the grounds of any alleged misstatement herein or in any advertisement.